



This project series incorporates everyone's lovable best friend, our pets! These creative and cute pet bandanas add the perfect touch to the style of any animal, big or small. The designs include ideas for dogs both cats. There are 2 different ways to create the pet bandana. The first way is to use a pre-made bandana or square of fabric and add the design to it using our in-the-hoop technique. The second way

involves a minimal amount of sewing and is created to slip around a collar. They are both very easy to create and we include complete sewing instructions for both versions.

Steve Wilson

SHOPPING LIST

PET BANDANAS

- One Fat Quarter or Ready-Made bandana
- Tearaway or No-Show Mesh stabilizer
- Embroidery Thread to coordinate with design.

IN YOUR SEWING ROOM

- Embroidery Machine, power chord and foot pedal
- Embroidery Hoop (make sure you bring the correct hoop size!)
- PROJECTS CD
- Sewing Machine Feet: Embroidery Foot, Regular Sewing Foot, Walking Foot

NOTIONS

- Scissors
- Ruler
- Rotary Cutter & Mat
- Pins
- Marking Pen or Chalk
- Tape
- Embroidery Needle, size 75/11
- Universal Needle, size 80/12

STYLE #1

Creating your own bandana

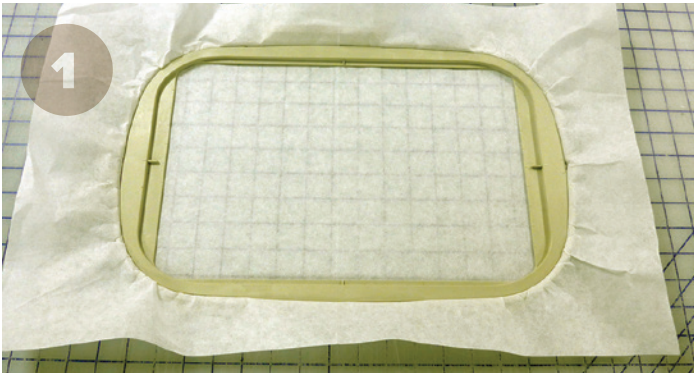

To begin your project start out by hooping a piece of no show mesh stabilizer. You may begin step one of the design which is the placement stitch.

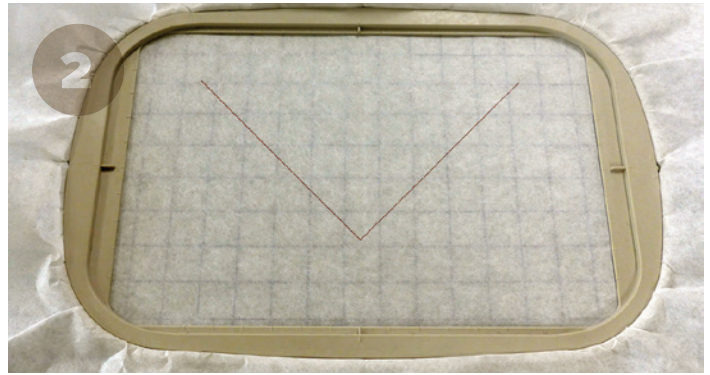

Your hoop should look like this after step one.

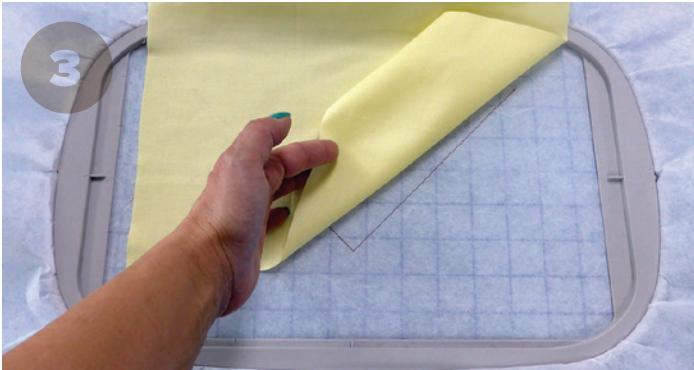

Next you will place your fabric over your placement stitch (about 1" below point) as shown. Note we pre-cut our fabric to 14" x 13".

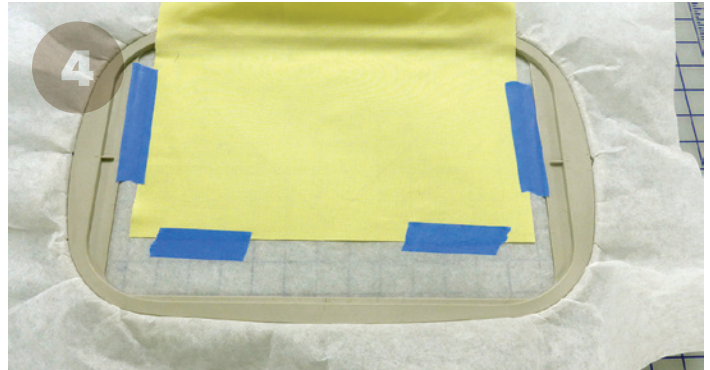

Tape fabric in place to prevent it from moving while sewing. You may begin step two of the design, this will be the tack down stitch which is a basing stitch that you will be removing later.

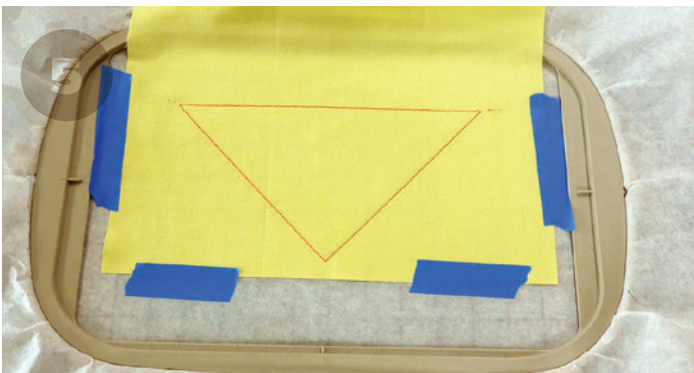

Your design should look like this after the placement stitch. You may continue with the rest of the embroidery design.



Your embroidery design should look like this when complete. You will now make your bandana.

STYLE #1

Creating your own bandana



To make your pet bandana you will first remove your design from the hoop and cut away the no show mesh. You can cut away the no show mesh at the placement stitch.

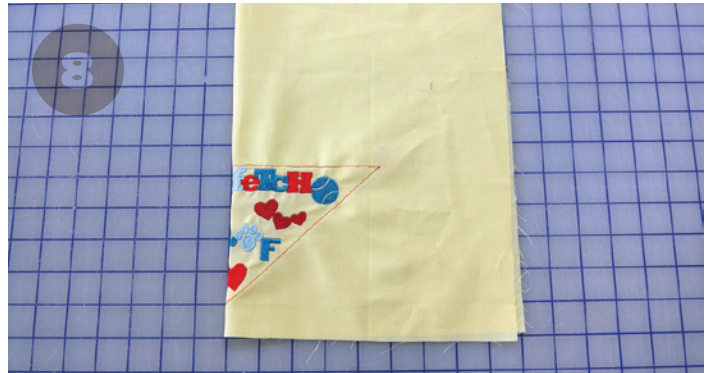

To begin making your pet bandana you will start out by folding your design in half, as shown. (Use the basting placement stitch as a guide)

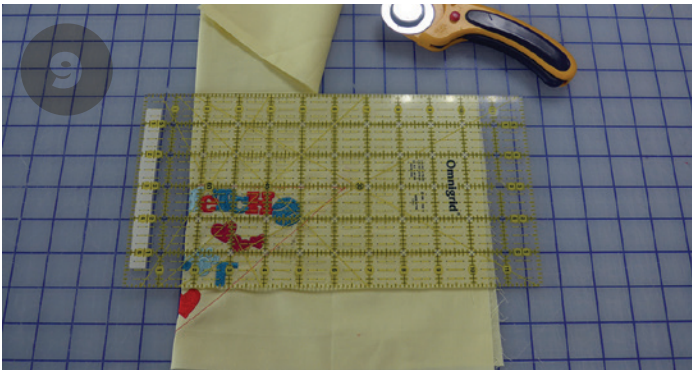

Next you will cut off the top of the bandana by placing your ruler 3" (for a size small collar) up from basting stitch as shown.

Note: Small Collar = 3"
Medium Collar = 3 1/2"
Large Collar = 4 1/2"

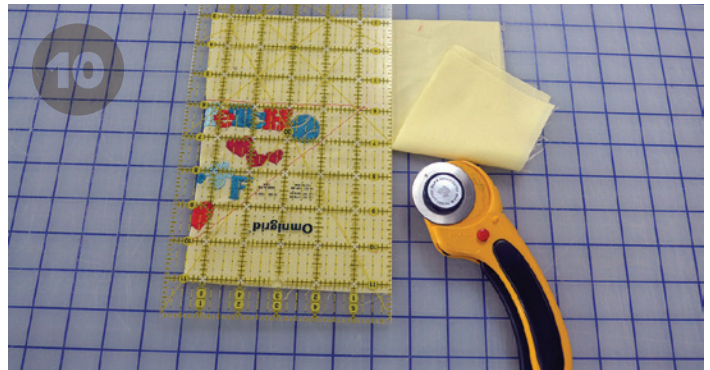

Next you will cut of the bandana to width by placing your ruler 5 1/2" (for a small collar) from fold line as shown.

Note: Small Collar = 5 1/2", 11" total cut width.
Medium Collar = 6", 12" total cut width.
Large Collar = 6 1/2", 13" total cut width.

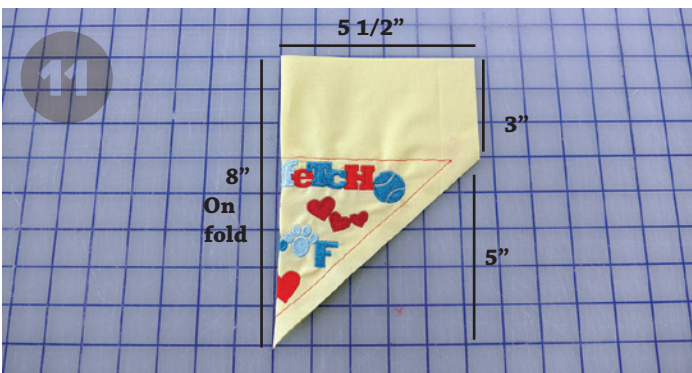

Finally you will cut your diagonal line from the fold line 5" (for all sizes) up as shown.

Note: Small Collar = 8" total cut length.
Medium Collar = 8 1/2" total cut length.
Large Collar = 9 1/2" total cut length.



At this point you may remove the basting stitches. This is what your pet bandana should look like once cut.

STYLE #1

Creating your own bandana



You now have a pattern to cut the back side of your bandana.



Place your cut bandana on top of your back fabric with right sides together as shown.



You may now cut out your back fabric.

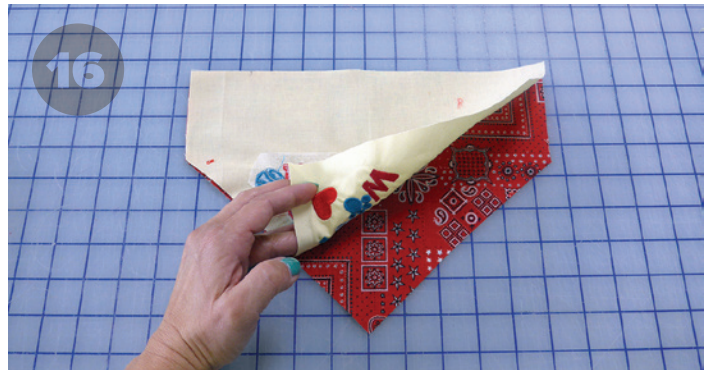

Once you have cut out your back fabric, your bandana will look like this. You will now sew the two pieces together.



You will sew the pieces together using a 1/4" seam allowance along the top edge and 1/2" seam allowance on all other edges. Make sure you leave an opening along the top edge to turn right sides out. We left a 3" opening. Your sample will look like this once all edges are sewn together.



Before you turn your bandana right side out you may want to clip your corners.

STYLE #1

Creating your own bandana

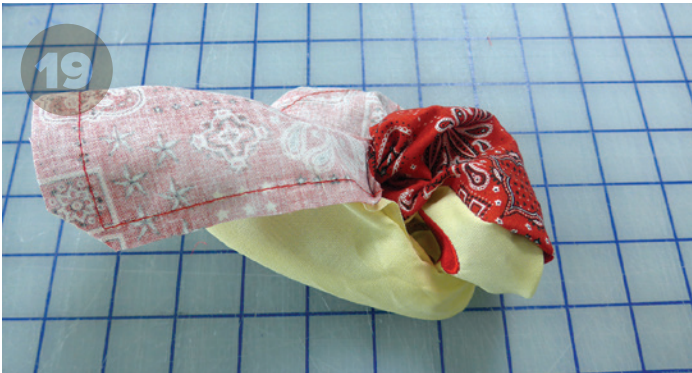

You are ready now to turn your bandana right side out.



Once you have turned your bandana completely right side out it should look like this. Press your bandana at this point.



You will now fold back the top edge to make a tunnel casing for your dog collar, edge-stitch in place.

Note: Small Collar = turn back 1"

Medium Collar = turn back 1 1/2"

Large Collar = turn back 2"



Your sample should look like this. Once you have edge-stitched the fold in place you can now feed through your collar.



This is what your small, medium and large collars will look like.

STYLE #2

Using a bandana

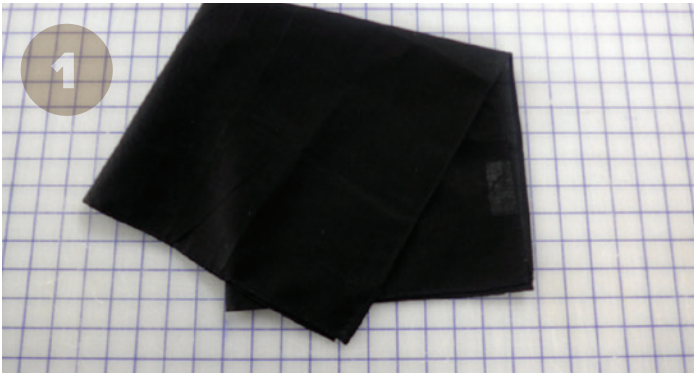

You can also make your pet bandana by using a ready made bandana. Shown is a plain black one.



To make your embroidery design on a ready made bandana begin by hooping a piece of tear away stabilizer. You may begin step one of your design which is the tacking stitch.



Once the tacking stitch is complete your hoop should look like this.

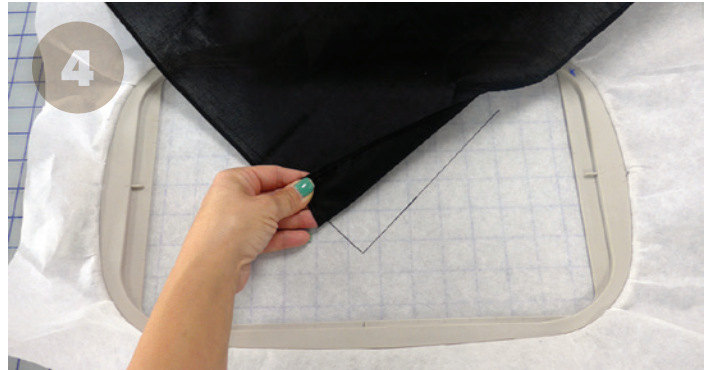

Place one corner of your bandana over your placement stitch. We set our bandana 1/4" down from tack stitch line.

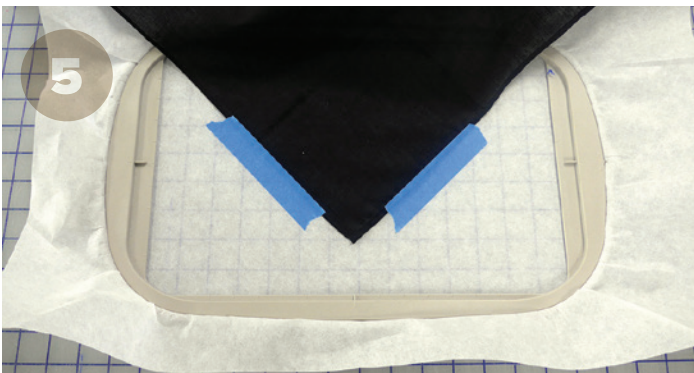

Once you have your bandana in place you will want to tape it in place to keep it from moving as shown. You may now begin step two of your embroidery design, the placement stitch.

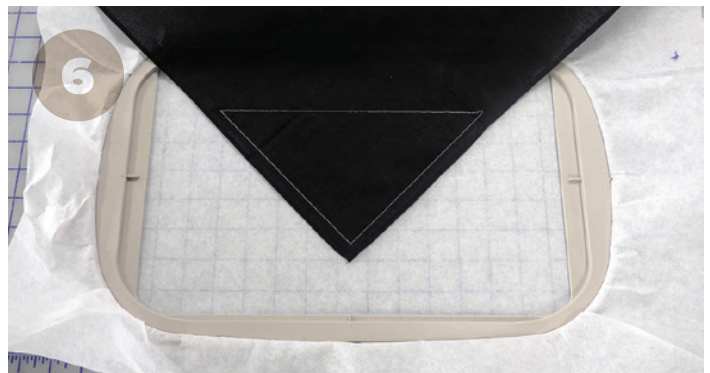

Once the placement stitch is complete your design should look like this. You may now complete the embroidery design.

STYLE #2

Using a bandana



Your sample will look like this once complete.



Before removing your bandana from the hoop remove basting stitches.



Once all basting stitches have been removed you may now tear bandana away from stabilizer.



Your bandana will look like this on the back side. Try to remove as much of the tear away stabilizer as you can.



Once complete your bandana will look like this.

DESIGNS

DESIGN - PB1A

Stitches - 19010
Size - 9.75" wide - 4.88" high

STEPS

1. Squaring Stitch - match fabric.
2. Tack Down Stitch - match fabric.
3. 1119 - Letter: I
4. 1121 - Larger heart
5. 1117 - Medium hearts
6. 1121 - Small hearts
7. 1586 - Dog bones
8. 1121 - Letters: t and T
9. 1586 - Letters: E and S
10. 1117 - Letters: R and a; hollow bottom heart.
11. 1121 - Inside bottom heart.



DESIGN - PB2A

Stitches - 10308
Size - 9.74" wide - 4.87" high

STEPS

1. Squaring Stitch - match fabric.
2. Tack Down Stitch - match fabric.
3. 391 - Inside of ribbon.
4. 368 - Outside of ribbon.
5. Placement Stitch - place appliqué after this step.
6. Tacking Stitch - match appliqué.
7. 522 - Outside of medal.
8. 503 - Inside and attachment for medal.
9. 503 - Ripples through medal.
10. 368 - 'TOP'
11. 190 - 'DOG'
12. 391 - Paw print.



DESIGNS

DESIGN - PB3A

Stitches - 16908
Size - 9.75" wide - 4.87" high

STEPS

1. Squaring Stitch - match fabric.
2. Tack Down Stitch - match fabric.
3. 702 - Large/medium heart, letters: e and H.
4. 372 - Letters: T, c and F. Ball and first paw print.
5. 391 - Letter: f and second paw print.
6. 190 - Letter W and cluster of hearts.
7. 745 - Dog bones.



DESIGN - PB4A

Stitches - 8271
Size - 9.75" wide - 4.88" high

STEPS

1. Squaring Stitch - match fabric.
2. Tack Down Stitch - match fabric.
3. Placement Stitch for appliqué - match fabric.
4. Tack Down Stitch for appliqué - match fabric.
5. 522 - Outer trim of appliqué.
6. 391 - Inside trim of appliqué.
7. 083 - 'Doggie Diva'.



DESIGNS

DESIGN - PB5A

Stitches - 7102

Size - 9.75" wide - 4.88" high



STEPS

1. Squaring Stitch - match fabric.
2. Tack Down Stitch - match fabric.
3. 372 - Letters: I, m, R, s and u.
4. 369 - Decorative swirls, the apostrophe, letters: a, e, c and e.

DESIGN - PB6A

Stitches - 6693

Size - 9.76" wide - 4.87" high

STEPS

1. Squaring Stitch - match fabric.
2. Tack Down Stitch - match fabric.
3. 800 - 'Throw me a'
4. 745 - 'Bone'.



DESIGNS

DESIGN - PB7A

Stitches - 11449

Size - 9.74" wide - 4.87" high

STEPS

1. Squaring Stitch - match fabric.
2. Tack Down Stitch - match fabric.
3. 800 - Shading in middle of paw.
4. 368 - Shading inside of paw print.
5. 368 - Inside satin stitches.
6. 800 - Outside satin stitches.



DESIGN - PB8A

Stitches - 9625

Size - 9.76" wide - 4.87" high

STEPS

1. Squaring Stitch - match fabric.
2. Tack Down Stitch - match fabric.
3. 7986 - 'Fur'.
4. 745 - 'BABY'.
5. 735 - Decorative stitches.



DESIGNS

DESIGN - PB9A

Stitches - 12496
Size - 9.75" wide - 4.87" high

STEPS

1. Squaring Stitch - match fabric.
2. Tack Down Stitch - match fabric.
3. 800 - Decorative stitches.
4. 369 - Paw prints and paisley stitches.
5. 523 - 'Best'
6. 190 - 'Friend'



DESIGN - PB10A

Stitches - 7205
Size - 9.75" wide - 4.88" high

STEPS

1. Squaring Stitch - match fabric.
2. Tack Down Stitch - match fabric.
3. 702 - Heart and paw prints.
4. 591 - Outline of heart and 'fur-ever'.
5. 372 - 'you'.



DESIGNS

DESIGN - PB11A

Stitches - 12275
Size - 9.75" wide - 4.88" high



STEPS

1. Squaring Stitch - match fabric.
2. Tack Down Stitch - match fabric.
3. 591 - 'Pet Me! please' and decorative stitches at bottom.
4. 372 - Larger bone at bottom.
5. 711 - Paw prints and upper bones.

DESIGN - PB12A

Stitches - 8828
Size - 9.75" wide - 4.87" high

STEPS

1. Squaring Stitch - match fabric.
2. Tack Down Stitch - match fabric.
3. 800 - Top outside hearts and 'WOOF!'.
4. 1586 - Top middle hearts, 'I' and 'you'.
5. 117 - Top inside hearts, middle hearts and lips.



DESIGNS

DESIGN - PB13A

Stitches - 8791
Size - 9.75" wide - 4.88" high



STEPS

1. Squaring Stitch - match fabric.
2. Tack Down Stitch - match fabric.
3. 745 - 'I'.
4. 190 - 'CHASE'.
5. 784 - Inside of squirrel.
6. 733 - belly.
7. 514 - Eye and acorn.
8. 7986 - Outline of squirrel.
9. 745 - Details of acorn and outline of tail.
10. 514 - Top of tail.
11. 564 - Ear.
12. 733 - Detail of ear.
13. 800 - Center of eye.

DESIGN - PB14A

Stitches - 16140
Size - 9.75" wide - 4.87" high

STEPS

1. Squaring Stitch - match fabric.
2. Tack Down Stitch - match fabric.
3. Placement Stitch - place appliqué after this step.
4. Tack Down Stitch - match appliqué.
5. 391 - Candle, tray for cake and two decorative stars.
6. 172 - Outline of cake and paw prints.
7. 083 - Two decorative stars and two bones inside cake.
8. 368 - Star, decorative swirl, inside of flame and three bones.
9. 137 - Decorative star, swirl and two bones inside cake.
10. 503 - Flame and decorative on cake.



DESIGNS

DESIGN - PB15A

Stitches - 9710

Size - 9.75" wide - 4.88" high



STEPS

1. Squaring Stitch - match fabric.
2. Tack Down Stitch - match fabric.
3. 501 - Attachments for gems and slender jewels.
4. 117 - Shading inside gems.
5. 106 - Part 1 of gem detail.
6. 083 - Part 2 of gem detail.
7. 1122 - Part 3 of gem detail.
8. 198 - Part 4 of gem detail.
9. 800 - Pearls and shadow of gems.
10. 083 - Pearl details.

DESIGN - PB16A

Stitches - 16153

Size - 9.75" wide - 4.88" high

STEPS

1. Squaring Stitch - match fabric.
2. Tack Down Stitch - match fabric.
3. Placement Stitch - place appliqué after this step.
4. Tack Down Stitch - match appliqué.
5. 137 - Base of cake and two stars.
6. 522 - Satin stitches around cake.
7. 151 - Two stars and details at top of cake layers.
8. 503 - Star, decorative swirl and outside of flame.
9. 172 - Star, decorative streamer and inside of flame.
10. 1084 - Paw prints and candle.
11. 137 - Decorative swirl on cake.
12. 371 - Inside of fish.
13. 373 - Details and outline of fish.



DESIGNS

DESIGN - PB17A

Stitches - 12151
Size - 9.75" wide - 4.87" high



STEPS

1. Squaring Stitch - match fabric.
2. Tack Down Stitch - match fabric.
3. 483 - Mice.
4. 106 - Paw prints and detail of mouse ears.
5. 487 - Whiskers and eyes for mice.
6. 800 - Skeleton of fish.
7. 503 - 'Meow'
8. 900 - Eye for fish.

DESIGN - PB18A

Stitches - 18792
Size - 9.75" wide - 4.87" high

STEPS

1. Squaring Stitch - match fabric.
2. Tack Down Stitch - match fabric.
3. 1084 - Hearts and yarn.
4. 1122 - Hearts, details for yarn, paw print and 'purrr'.
5. 371 - Inside of fish.
6. 373 - Details for fish, paw print and 'purrr'.
7. 133 - Yarn.
8. 137 - Details for yarn, paw print and 'purrr'.



DESIGNS

DESIGN - PB19A

Stitches - 21577

Size - 9.74" wide - 4.87" high

STEPS

1. Squaring Stitch - match fabric.
2. Tack Down Stitch - match fabric.
3. 172 - Bones.
4. 800 - String and details for bone.
5. 1084 - Details for decorative on bones and jewels.
6. 371 - Paw print and decorative on bones and jewels.
7. 522 - Decorative on bones and jewels.
8. 137 - Decorative on bones and jewels.



DESIGN - PB20A

Stitches - 9248

Size - 9.75" wide - 4.87" high

STEPS

1. Squaring Stitch - match fabric.
2. Tack Down Stitch - match fabric.
3. 800 - Details for tux.
4. 900 - Details on buttons.
5. 702 - Bow Tie.
6. 190 - Details for bow tie.

